

foil

USER'S GUIDE

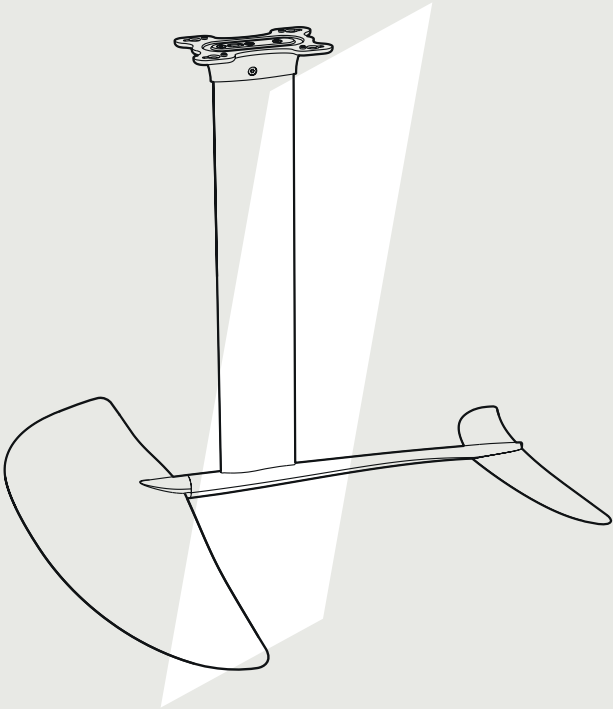

takuma
fly above water

Thank you for choosing the **TAKUMA FOIL**

Make sure you are able to use this product in a safe and responsible manner. Do not use it if you are not in good physical health, if you are not an experienced swimmer, or if you are under the influence of alcohol, drugs or medications.

The use of a foil exposes you and others around you to serious risks, the wings and mast have sharp edges that could cause serious bodily harm, even death. It is recommended to take lessons by a certified instructor before using this product on your own.

Always make sure you are using this product at a safe distance from others and away from any obstacles. Check for any legal requirements and rules that may apply in your location. Observe local weather forecasts and never go out in dangerous conditions. Take care when handling the foil and always store it in its protective carrying case.

The following are required when using your **FOIL**:

a certified personal flotation device (PFD)

a certified helmet

a full neoprene wetsuit, booties and gloves

By using this product, you agree that you do so at your own risk. TAKUMA does not accept any responsibility for personal injury or material damage in the case of an accident due to incorrect use.



Assembly video tutorials

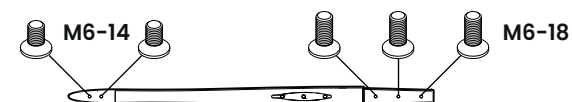

Back wing shim



Top plate shim

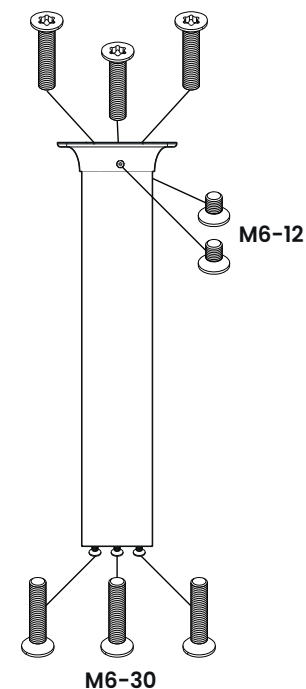
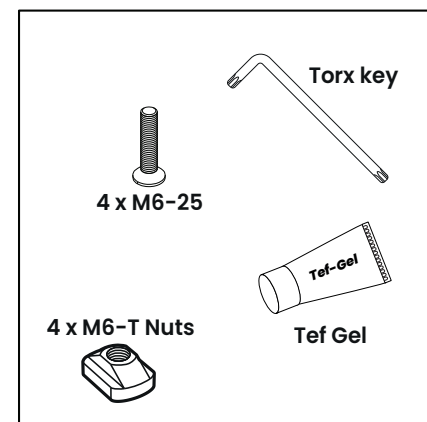



Apply a thin layer of **Tef Gel** on all screws before use to avoid corrosion.

1

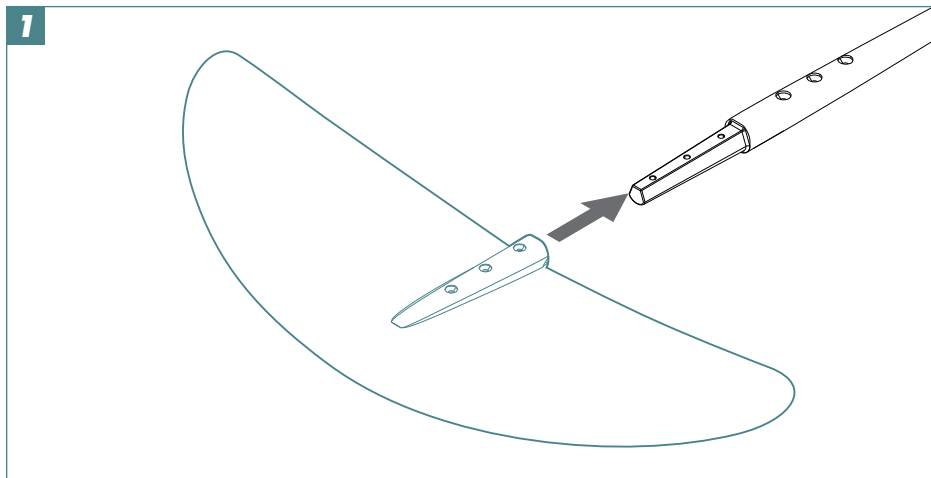

2

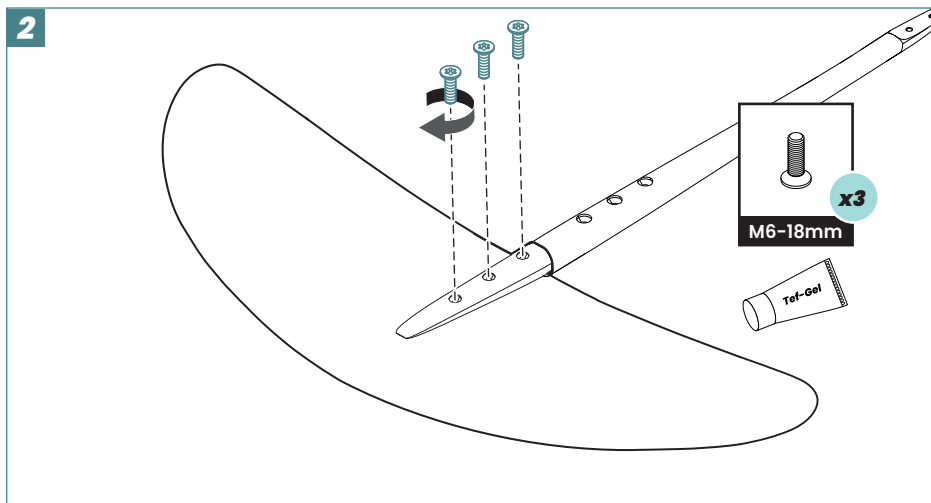

3

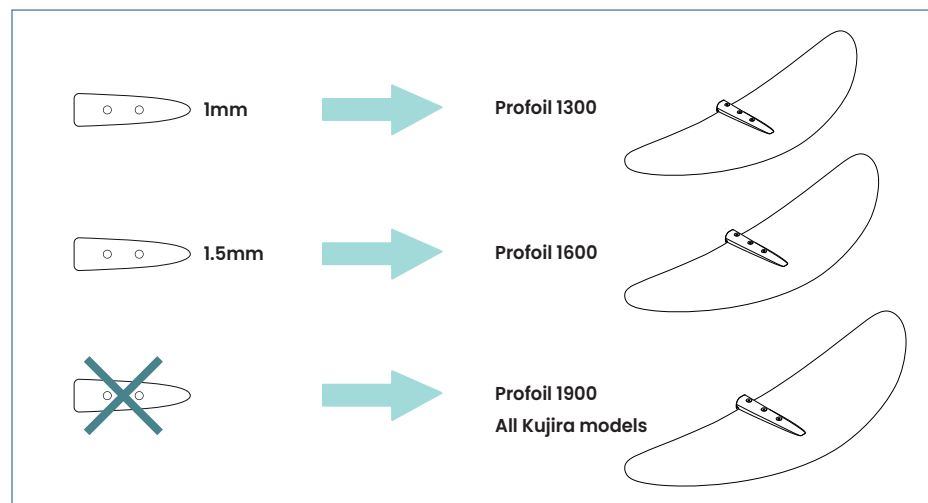
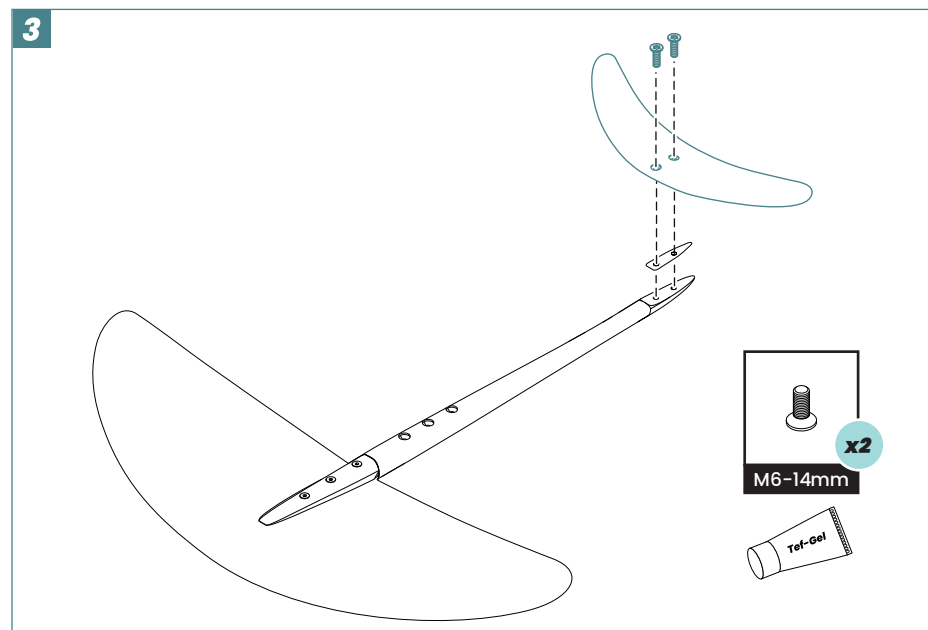

4

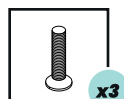

M6-30mm

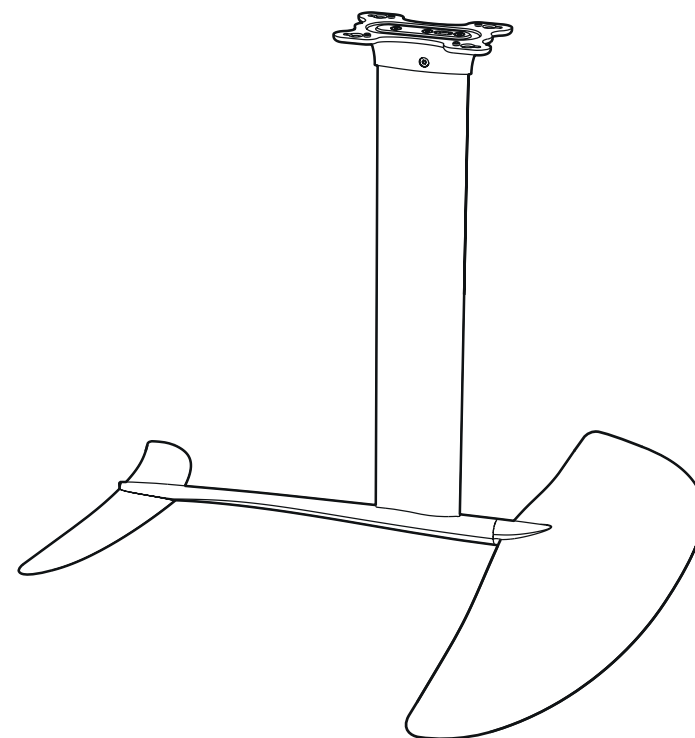
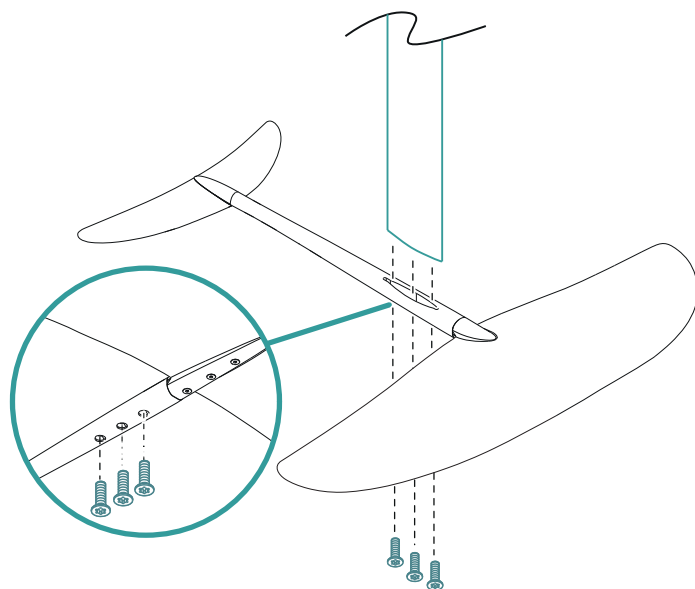

Foil mount

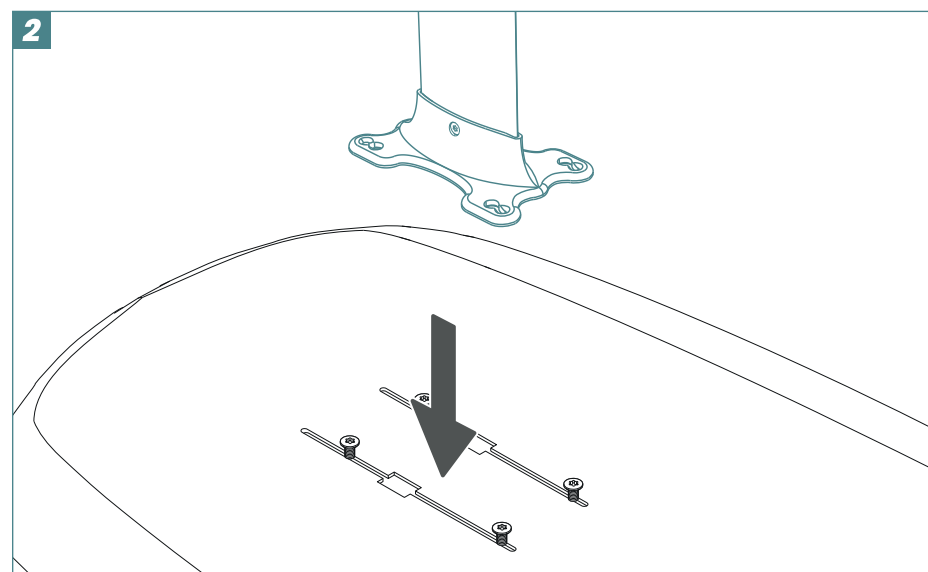
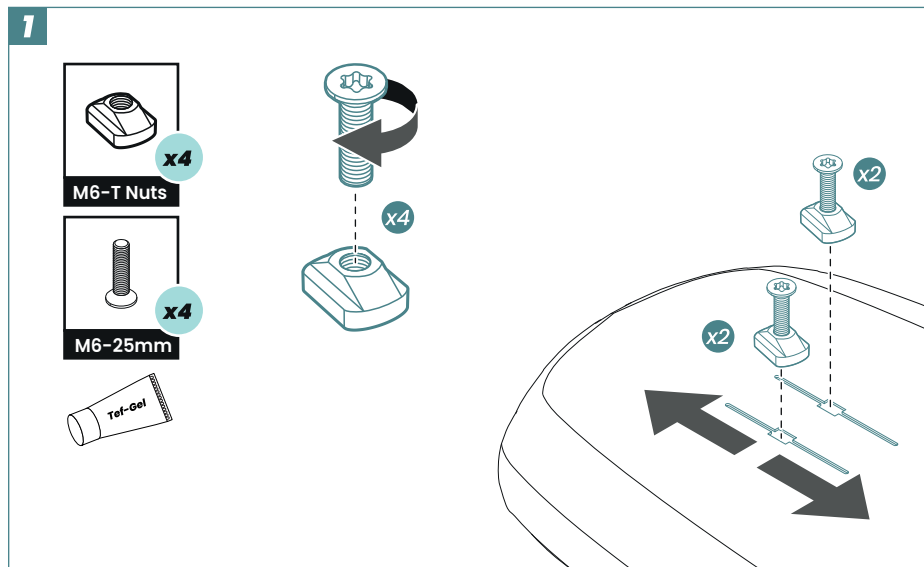
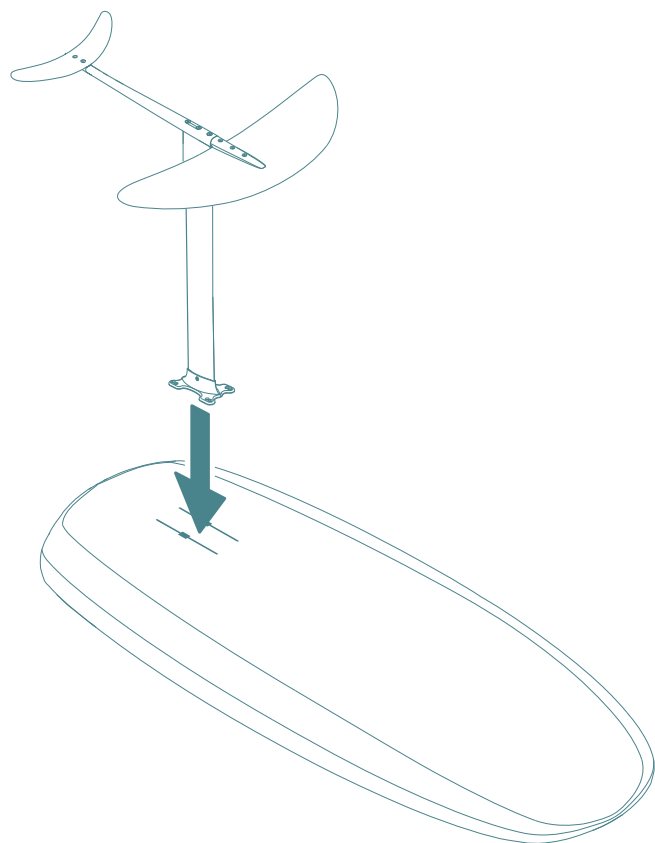

3

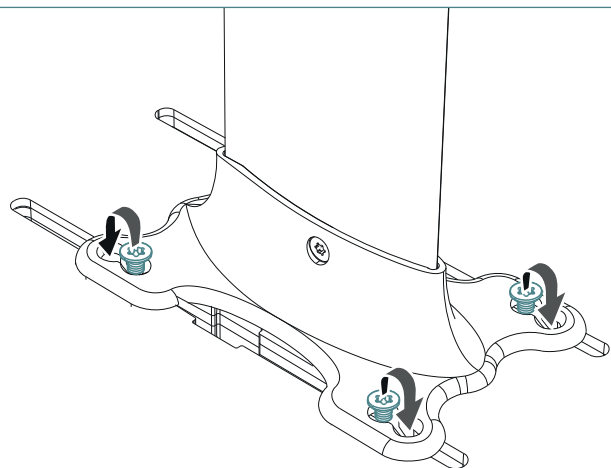

4

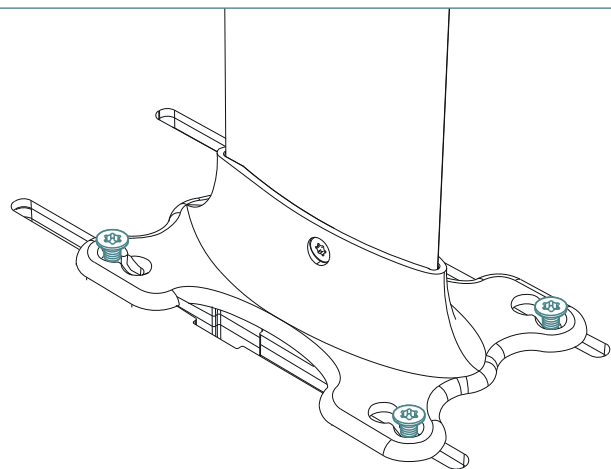

5

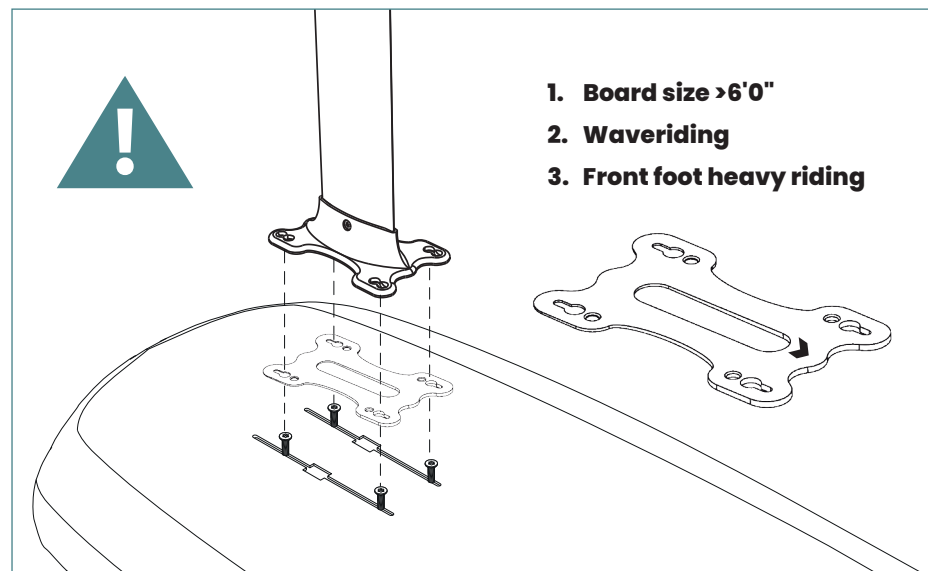
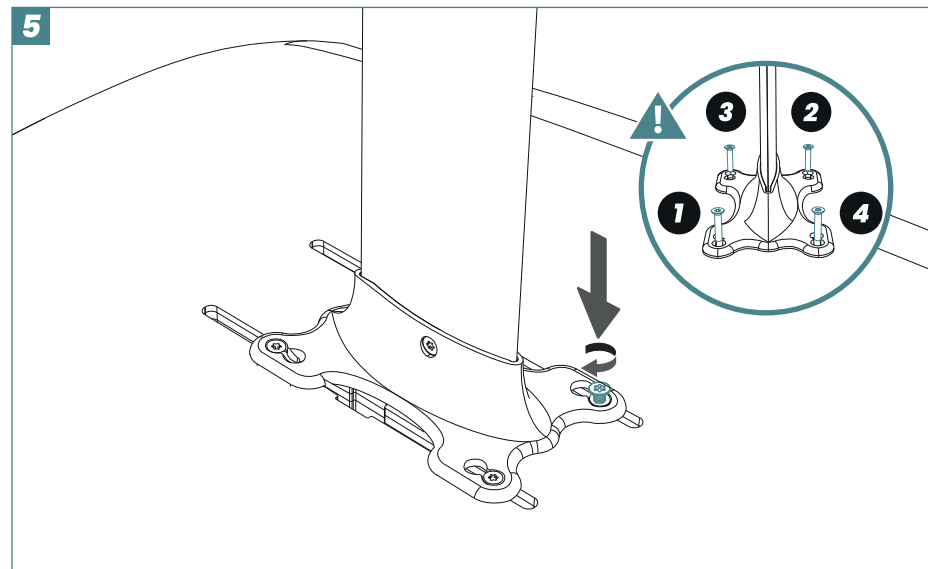

Foil removal

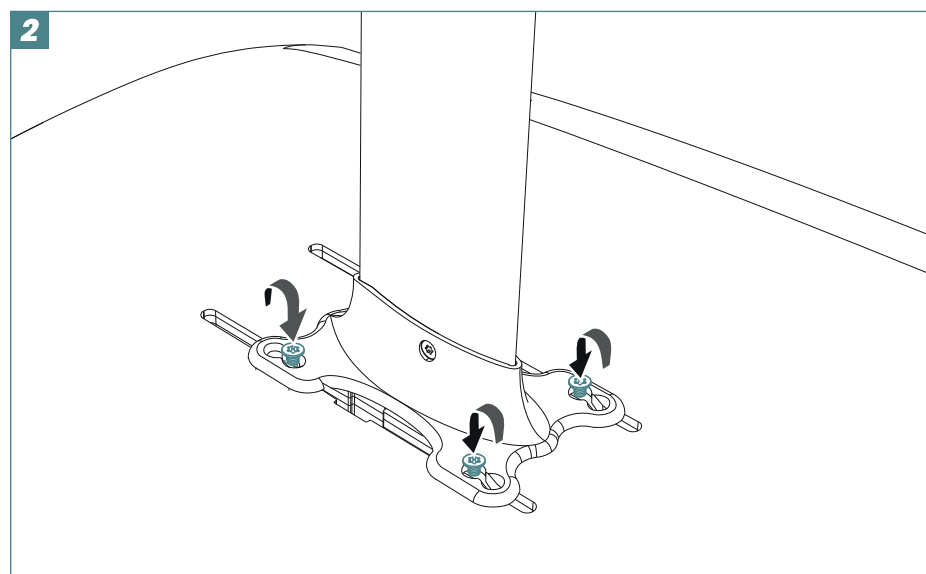
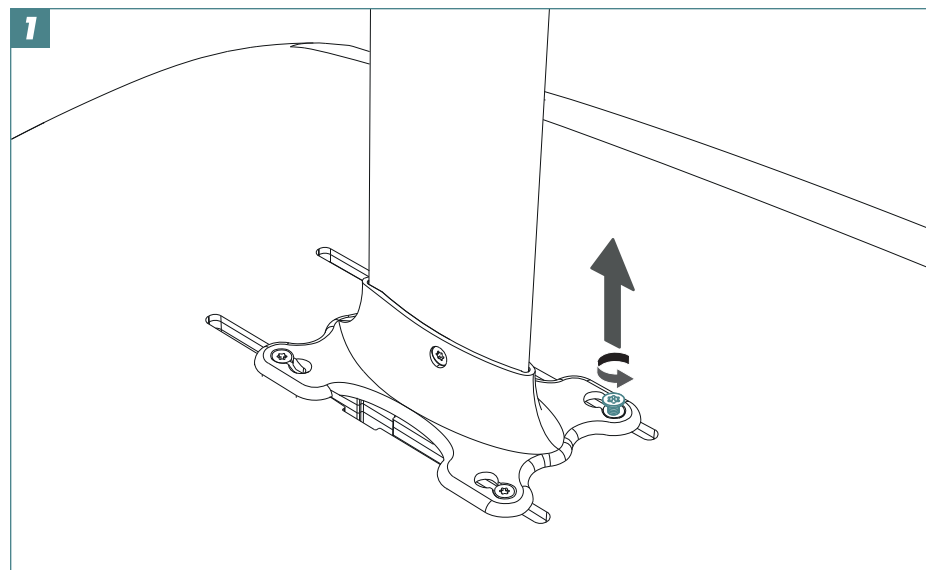
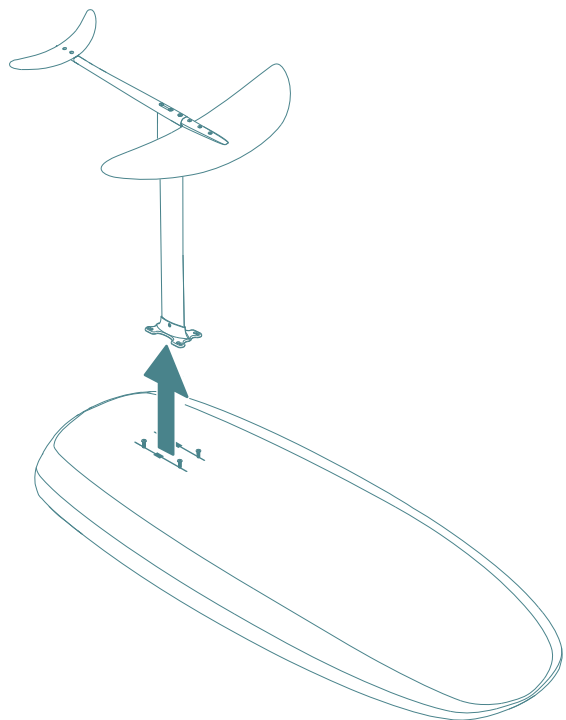

3

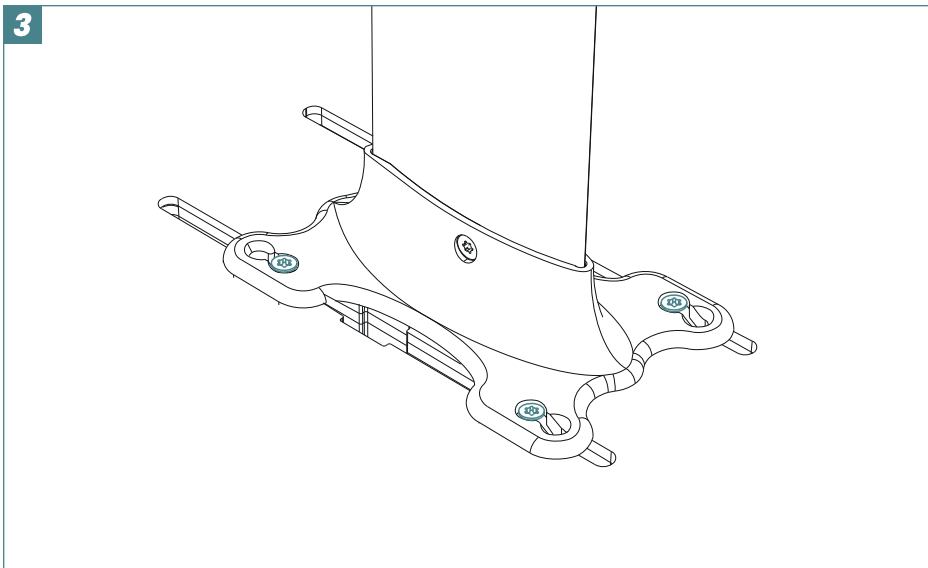

4

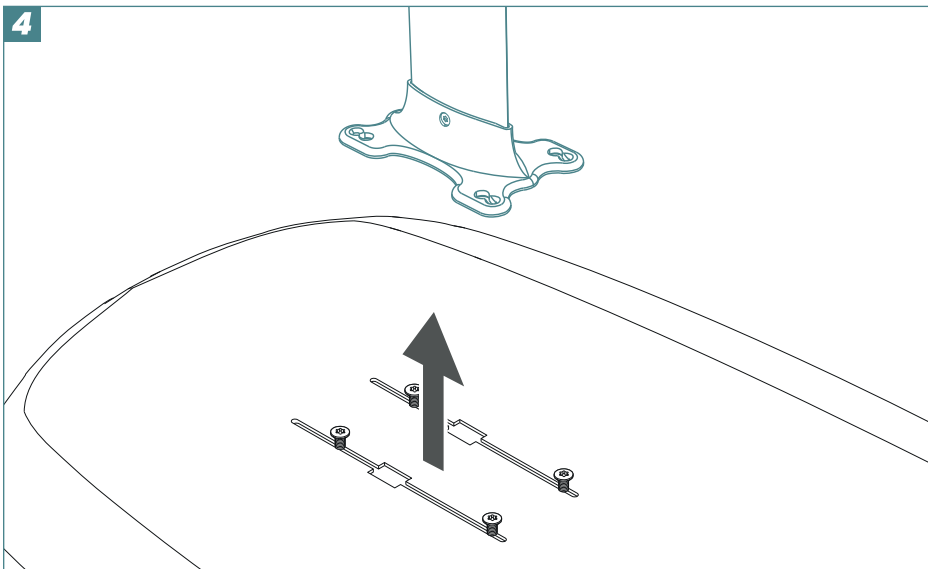

Innovative Top Plate Design

For quick and easy installation, allowing you to maintain the same position each time you reattach the foil.

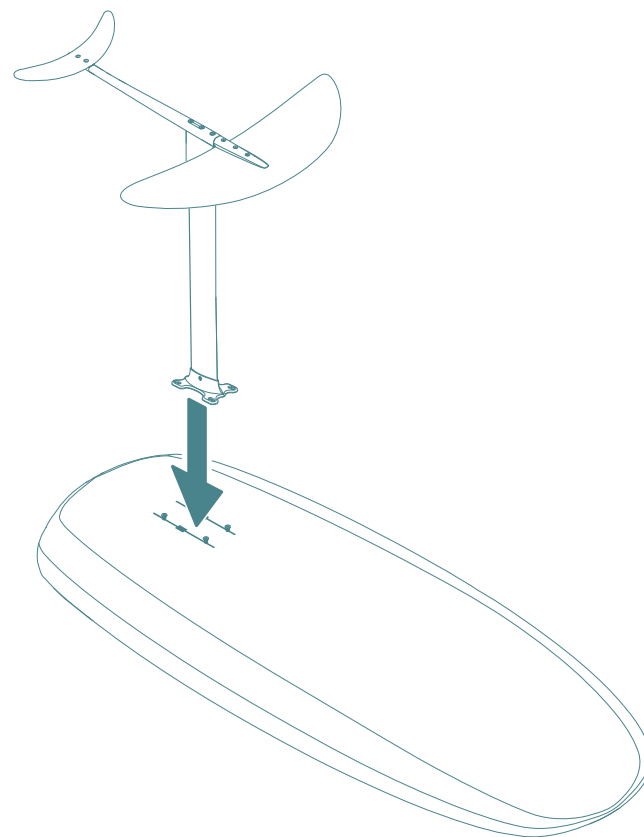

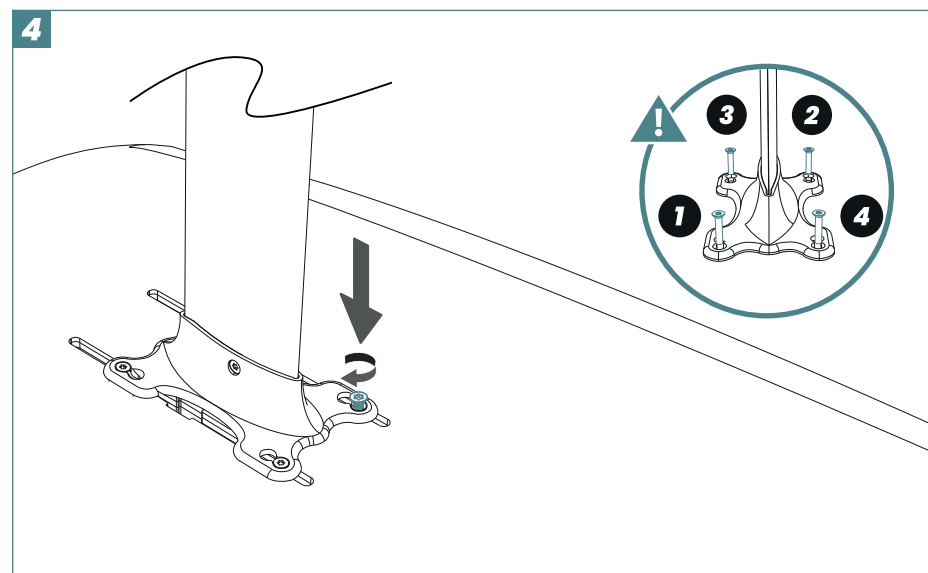
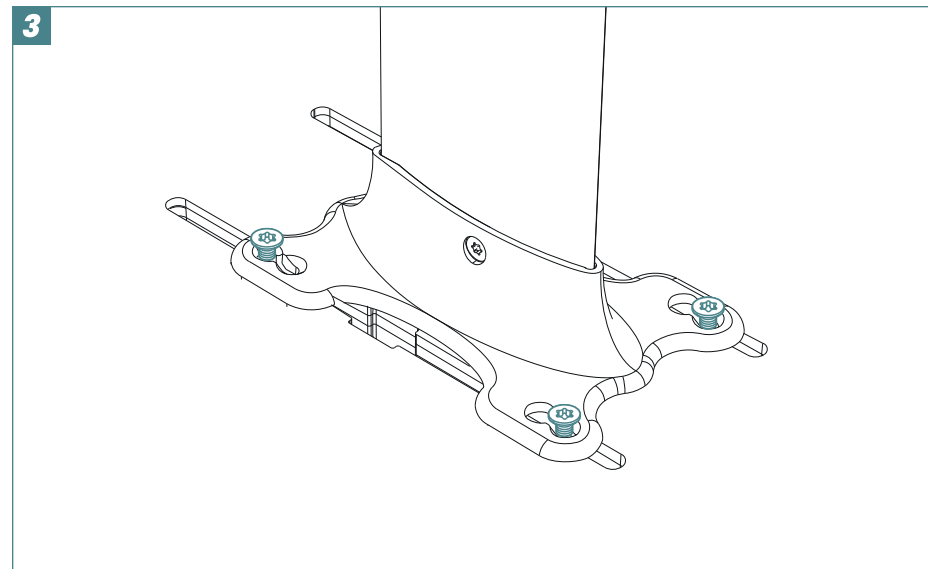
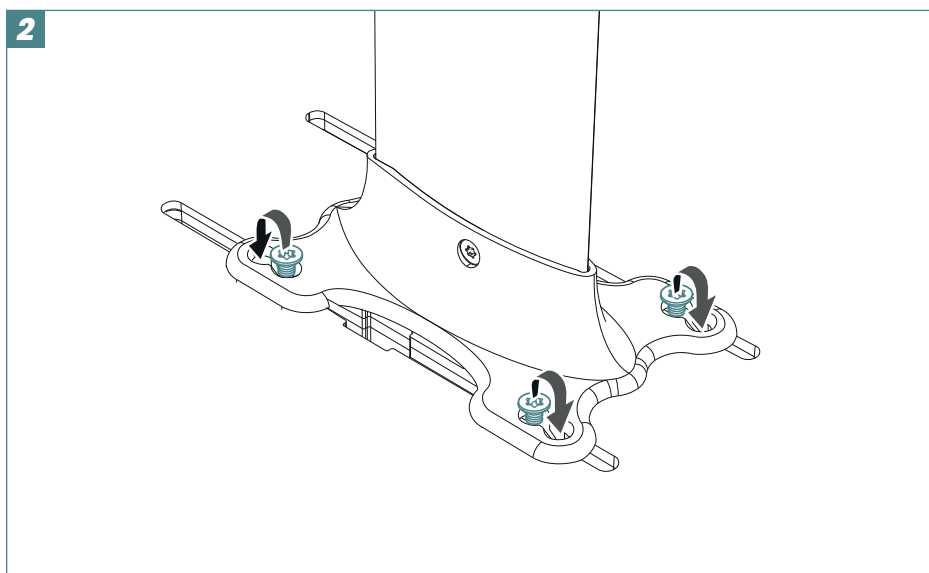
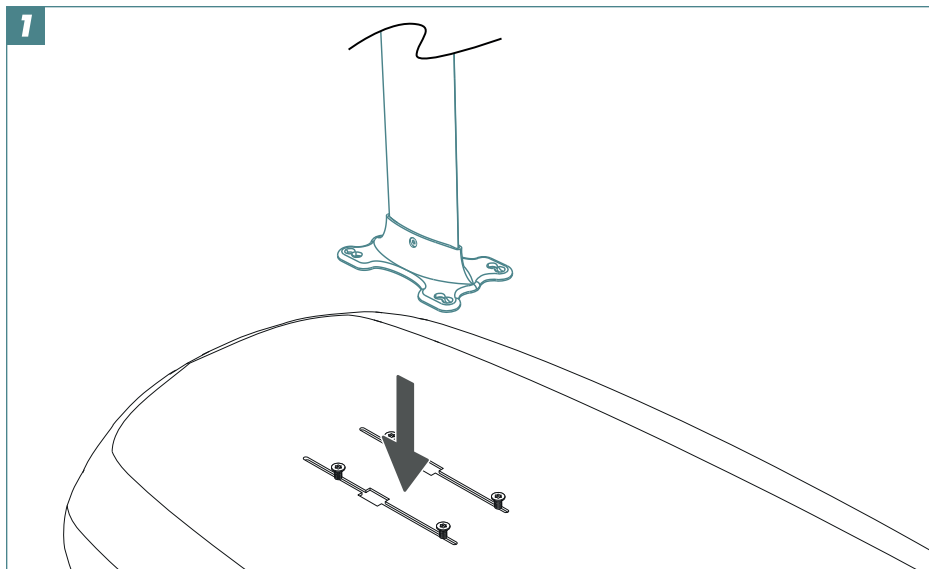

Optimum position

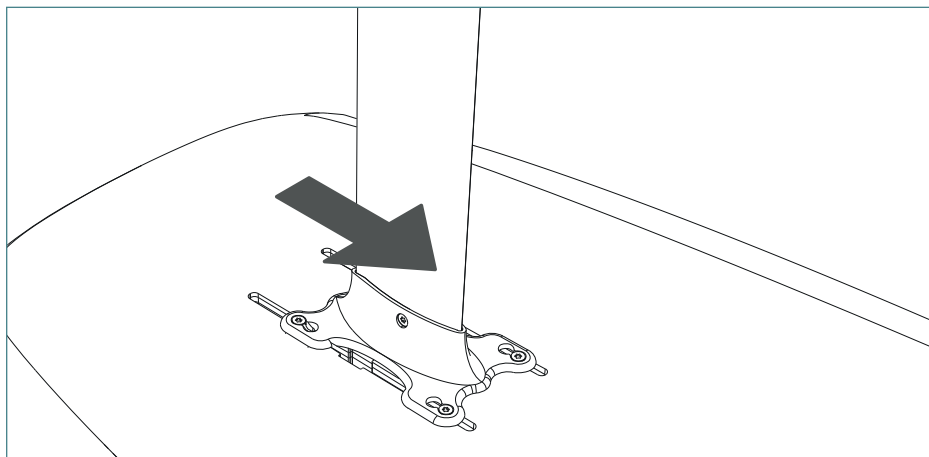

If there is too much lift

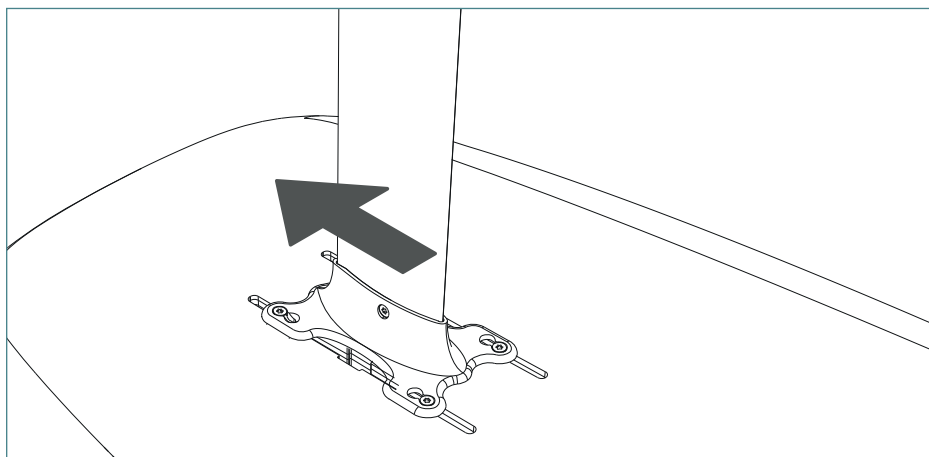

Warranty of hidden defects

TAKUMA is liable for hidden defects in the Product exclusively under the conditions detailed in this article. Subject to valid proof of purchase, the BUYER may assert the warranty against hidden defects within one year (EU consumers have two years according to EU legislation). The PURCHASER must imperatively provide proof that the defect was not apparent, that the defect existed at the time of purchase and that the defect renders the Product unfit for the use for which it is intended, or greatly reduces this use. In the event that the proof conditions are perfectly fulfilled by the BUYER, the latter has an option between the resolution of the Order or a reduction in the price of the Order. In the event of the BUYER's failure to provide proof of the hidden defect, TAKUMA is not bound by any warranty.

Warranty of conformity

TAKUMA is liable for any lack of conformity of the Product, under the conditions of this article. Subject to valid proof of purchase, the BUYER has a period of one year (EU consumers have two years according to EU legislation) from the delivery of the Product to request the guarantee of conformity. In the event of a lack of conformity, the BUYER has an option between repair or replacement of the Product. However, if the option chosen by the BUYER results in costs clearly disproportionate to the other option, TAKUMA may proceed as it sees fit. In the event that neither repair nor replacement can be carried out by TAKUMA in the month following the complaint, TAKUMA may proceed, according to the choice of the PURCHASER, to a reduction in the price of the Order or to a full refund of the price of the Order, except by exception, in the event of a minor defect on the Product, according to the reasoned assessment of TAKUMA.

Warranty does not cover

Costs of return shipments to Takuma or authorized Takuma representative, any repair or replacement of any product due to ordinary wear and tear, including scratches, paint chipping or fading; or for any damage caused by misuse, abuse, unauthorized modification or repairs, accident, heat, excessive exposure to sunlight, improper handling, storage, maintenance or care; incorrect setup, use in commercial, rental or teaching environments; use in reef waves, shorebreak or off the water; any blow or impact with a hard object or any other irresponsible use; when being classified as second hand; consequential and incidental damages or expenses, including damages to property or for personal injury.



After-Sales Service:

customerservices@takuma.com

Please find our tutorial videos on our youtube channel:

<http://youtube.takuma.com>

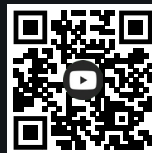

Other languages:

*Español / Deutsche / Italiano / Português / Polskie / Română / Slovák /
Slovenščina / Български / čeština / Русский / Hrvatski / Lietuvių / Magyar /
Svenska / 中文 / 日本語*

